

REV	DESCRIPTION	DATE	APPROVED
A	IR601884	2024-05-01	SRC

NOTES: UNLESS OTHERWISE SPECIFIED

- RISER ASSEMBLY INTERFACES DIRECTLY WITH LINKALIGN-360MPT-50 SERIES AND LINKALIGN-360MPT-90 SERIES POSITIONERS
- HARD COAT ANODIZE ALUMINUM CONSTRUCTION WITH ZINC-PLATED ALLOY STEEL FASTENERS TO CONNECT TOP AND BOTTOM MOUNTING PLATES TO RISER TUBE
- WEIGHT: APPROXIMATELY 71 LBS (32.2 kg)
- MAXIMUM PAYLOAD NOT TO EXCEED 2,000 LBS (907 kg)
- MOUNTING HARDWARE PROVIDED (NOT SHOWN) INCLUDES (4) ZINC YELLOW-CHROMATE PLATED GRADE 8 STEEL 3/4-10 X 4-1/2 LONG HEX HEAD SCREWS, (8) ZINC YELLOW-CHROMATE PLATED GRADE 8 STEEL 3/4 FLAT WASHERS, (4) ZINC YELLOW-CHROMATE PLATED GRADE 8 STEEL 3/4 SPLIT LOCK WASHERS AND (4) ZINC YELLOW-CHROMATE PLATED GRADE 8 STEEL 3/4-10 HEX NUTS

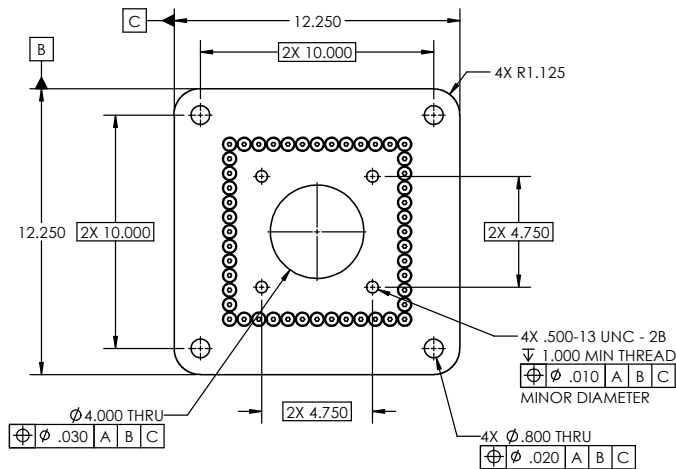

FEATURES IN THIS VIEW ON BOTH ENDS OF RISER ASSEMBLY

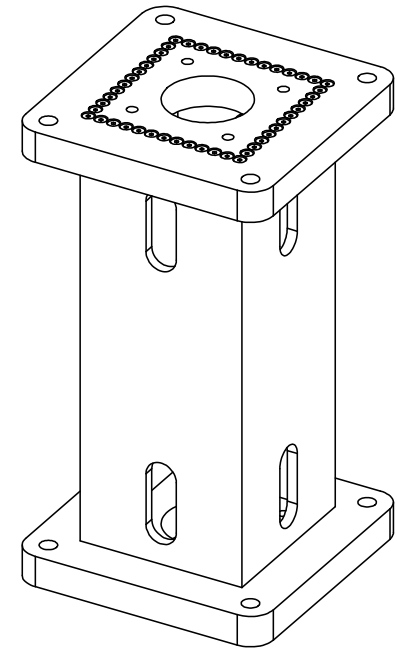

SCALE: NONE

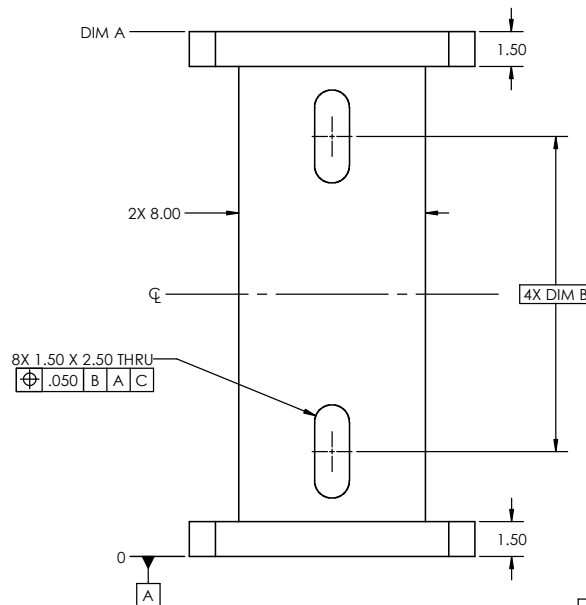

PART NUMBER	HEIGHT - DIM A	SLOT SEPARATION - DIM B
ACC-N901504-22.5	22.500 ± .125	13.50

SYMBOL KEY □ NOTE ○ PL ITEMS PROPRIETARY AND CONFIDENTIAL THE INFORMATION CONTAINED IN THIS DRAWING IS THE SOLE PROPERTY OF QPAR ANTENNAS USA, LLC. ANY REPRODUCTION IN PART OR AS A WHOLE WITHOUT THE WRITTEN PERMISSION OF NEXTMOVE TECHNOLOGIES IS PROHIBITED. QPAR ANTENNAS USA, LLC SAN DIEGO, CA 92120 www.qparusa.com	UNLESS OTHERWISE SPECIFIED: DIMENSIONS ARE IN INCHES TOLERANCES ANGLE ± .5 DEGREES TWO PLACE DECIMAL ±.030 THREE PLACE DECIMAL ±.010 INTERPRET DIM AND TOL PER ASME Y14.5M - 1994	DRAWN	S. CHEYNE	2024-05-01	QPAR ANTENNAS USA, LLC TITLE: INTERFACE CONTROL DRAWING, RISER ASSEMBLY, MPT-50/90
		CHECKED			
		ME APPR.	S. CHEYNE	2024-05-01	
		EE APPR.			REV C ICDN901504 A
THIRD ANGLE PROJECTION DO NOT SCALE DRAWING		PART NO. SEE TABLE I		SIZE C	DWG. NO. ICDN901504
		SCALE: 1:4		SHEET 1 OF 1	